

Steaming Hot Water Tap Installation criteria

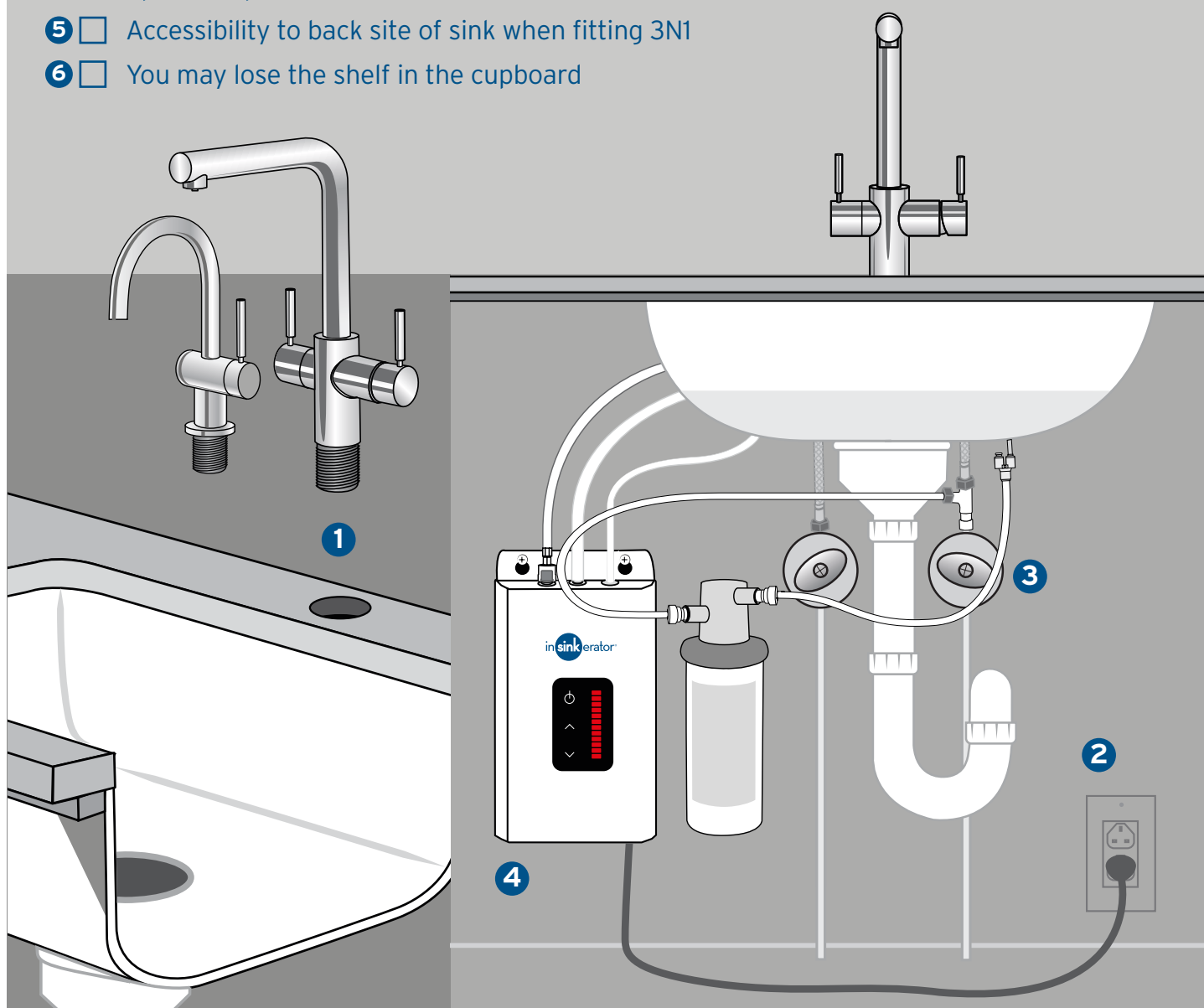

Customer Criteria for Steaming Hot Water Taps

- 1 For tap fitment a pre-drilled hole is required in any work surface other than wood composition
- 2 13 amp power socket must be within 600mm of install area
- 3 Stopcock working and accessible
- 4 Space for product (check website for dimensions)
- 5 Accessibility to back site of sink when fitting 3N1
- 6 You may lose the shelf in the cupboard



The appliance will be connected to existing services only. Should a hole not be pre-drilled in any work surface other than wood, installation will not be possible. If the criteria above has not been met on the arrival of the service agent, the customer will have to pay a call out charge of £65 to the service agent.

Please contact us if you are unsure
of any of the above on **01923 297 880**